

Technical Data Sheet

S224 Stainless Steel Ball Bearing Butt Hinge 100x75x2.5mm

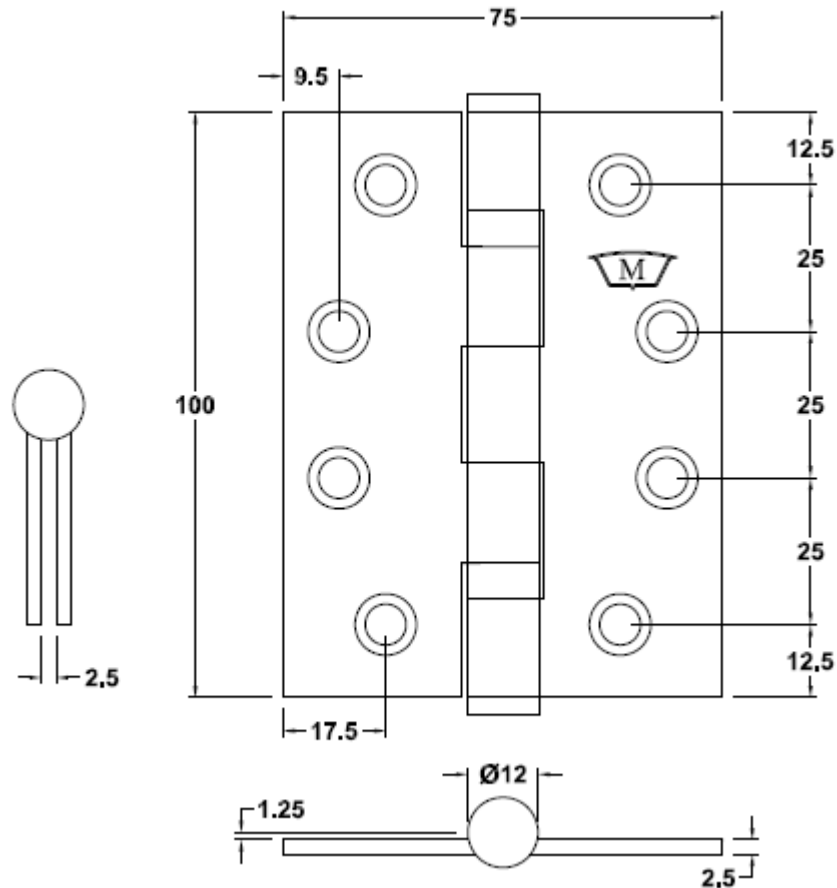

SPECIFICATION

- **Hinge Type:** Ball Bearing Butt – Fixed Pin
- **Material:** Stainless Steel 304 grade
- **Hinge Pin:** 6.9mm Diameter Stainless Steel 304 grade
- **Bearing:** Stainless Steel – Cage & Bearing
- **Knuckle:** Round
- **Endcaps:** Stainless Steel 304 grade Pressed Interference fit
- **Fixing Holes:** Industry Standard hole pattern to suit pressed metal frames
- **Fire Rated:** Yes

FINISH

- S224SSS – Satin Stainless Steel
- S224PSS – Polished Stainless Steel
- S224BLK – Black
- S224PVD – PVD

INSTALLATION GUIDE

- Minimum Door Thickness 35mm
- Suitable for Timber doors with Timber or Metal frames
- As a guide doors:
 - 2040 high x 820 wide – 3 hinges
- Recommended that the minimum of 3 hinges be used with the top hinge located as high as possible

FIXING

- Fastening screws supplied
- Metal fixings – M5 x 12mm, Countersunk Phillips Stainless Steel metal screw
- Timber fixings – 10G x 32mm 304SS type AB self-tapping Phillips drive screw